

# Wheeler-Rex Pipe Hog and Fitting Saver



## PIPE HOG® PVC / ABS FITTING REAMER

Quickly and accurately bores out solvent welded fittings to make repairs. Saves time and material. Pays for itself in one use.

<b>16150</b>	1 1/2" Pipe Hog for Schedule 40.....	9 oz.
<b>16200</b>	2" Pipe Hog for Schedule 40.....	12 oz.
<b>16300</b>	3" Pipe Hog for Schedule 40.....	1 lbs. 2 oz.
<b>16400</b>	4" Pipe Hog for Schedule 40.....	1 lbs. 8 oz.
<b>16010</b>	Pipe Hog Kit with extension shaft.....	8 lbs. 4 oz.

### Accessories:

<b>700588</b>	Schedule 80 guide for 16150.....	
<b>700589</b>	Schedule 80 guide for 16200.....	
<b>700590</b>	Schedule 80 guide for 16300.....	
<b>700591</b>	Schedule 80 guide for 16400.....	
<b>16050</b>	12" extension shaft.....	
<b>16055</b>	1/2" square carbide insert.....	

Pat. No. 3,752,593

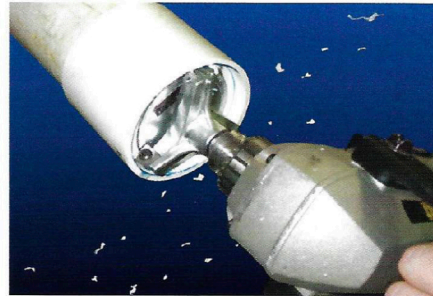

## FITTING SAVER

Quickly and easily removes pipe from solvent welded or threaded fittings. Saves time and money over replacing whole assemblies. Perfect for plumbing, irrigation and sprinkler contractors. Each tool comes supplied with tips for Schedule 40 and Schedule 80.

<b>17050</b>	1/2" IPS Fitting Saver.....	.25 lbs.
<b>17075</b>	3/4" IPS Fitting Saver.....	.35 lbs.
<b>17100</b>	1" IPS Fitting Saver.....	.50 lbs.
<b>17010</b>	Fitting Saver Kit (contains 17050, 17075, 17100 Fitting Savers in case).....	1.6 lbs.
<b>18050</b>	1/2" CTS Fitting Saver.....	.15lbs.
<b>18075</b>	3/4" CTS Fitting Saver.....	.20lbs.

### BEFORE

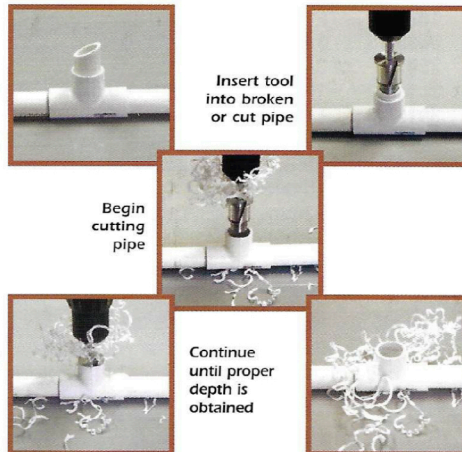

### AFTER

